







Prout Range	Power (W)	Standard 	Standard & Nema 	Dali 	Dali & Nema 	AstroDim 	Windage - Surface (m <sup>2</sup> )
CQ150	150	14.5	14.5	14.5	14.5	14.5	0.29
CQ175	175	14.5	14.5	14.5	14.5	14.5	0.29
CQ200	200	14.5	14.5	14.5	14.5	14.5	0.29
	IP	66	65	66	65	65	



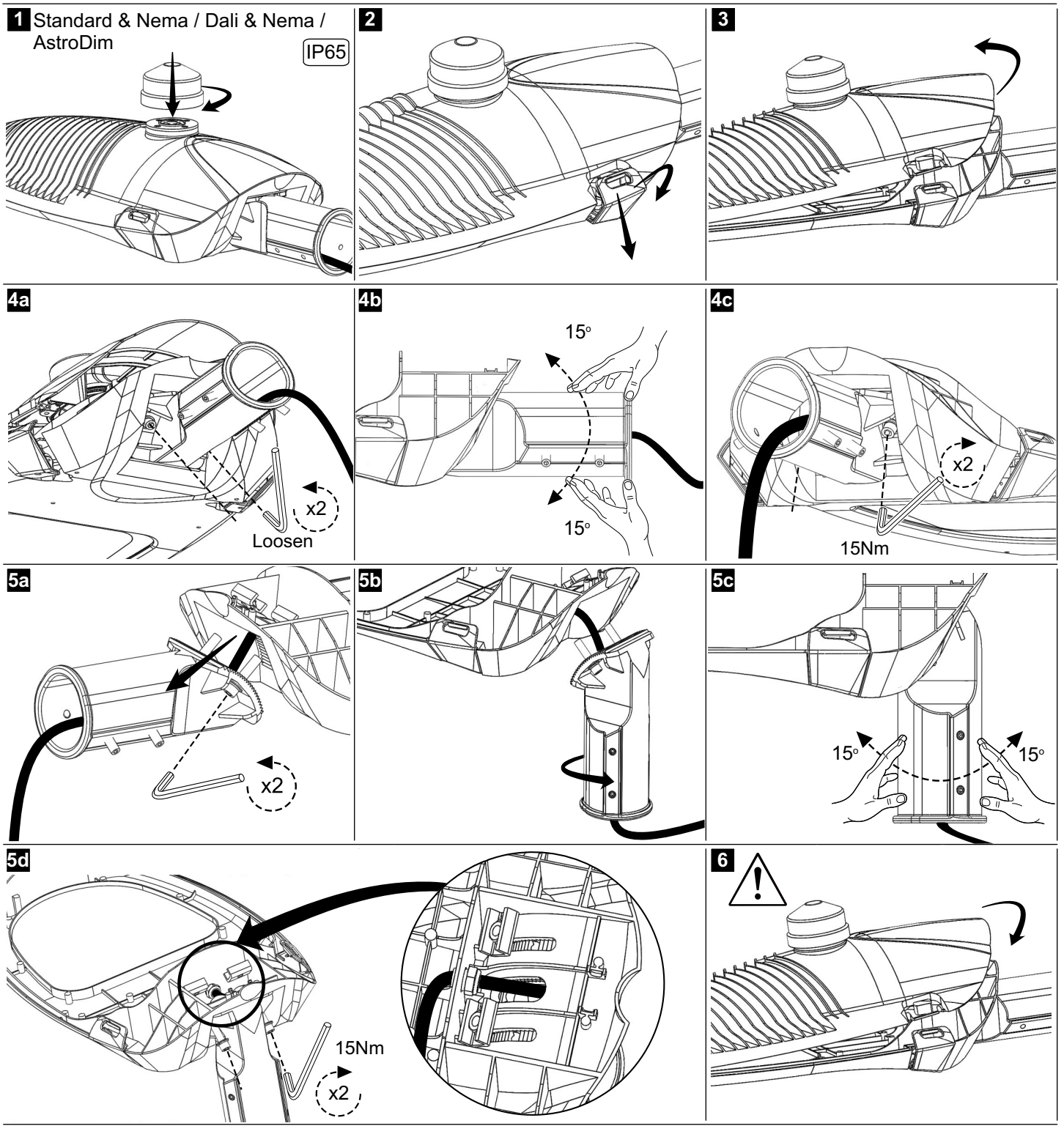
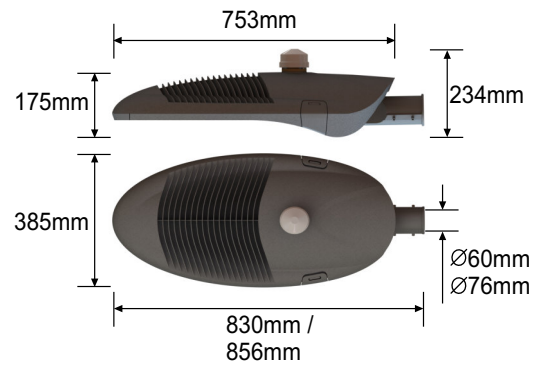
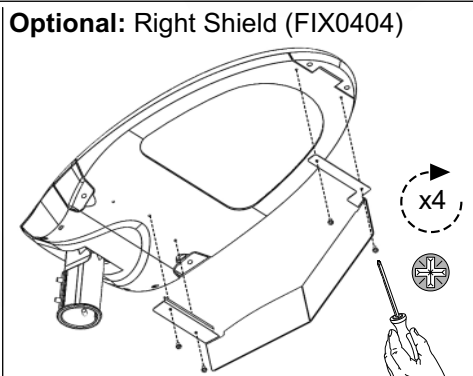
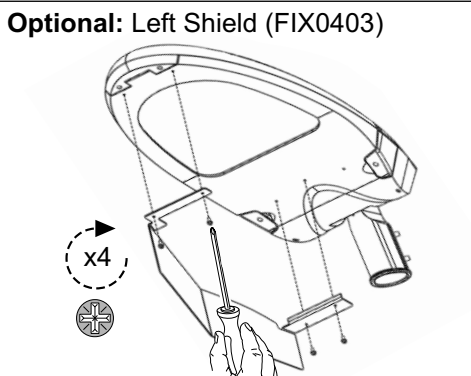
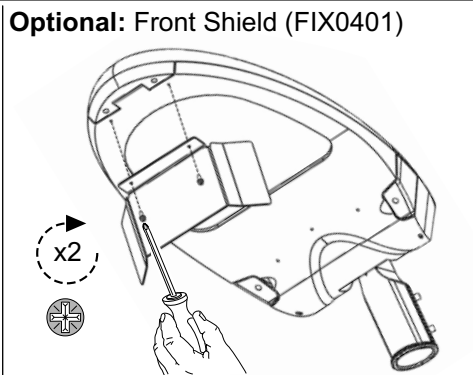
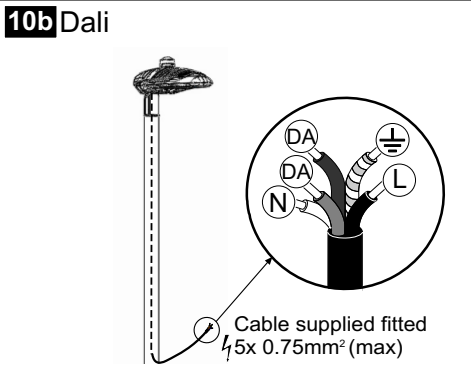
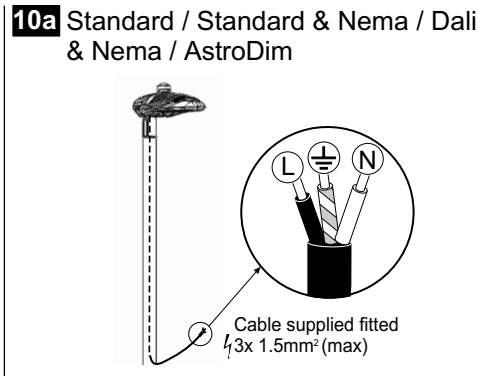
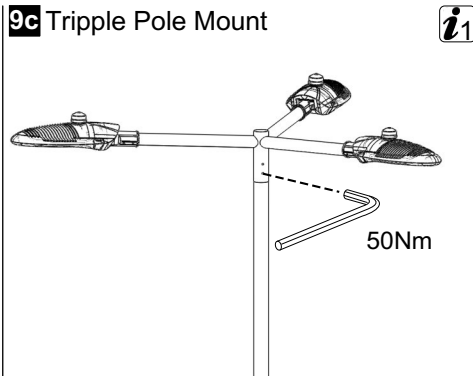
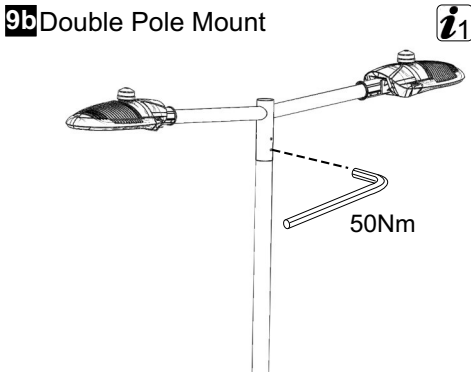
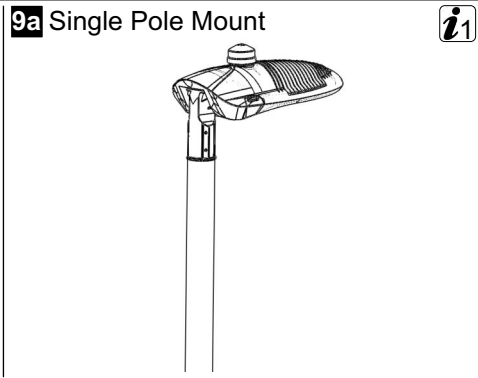
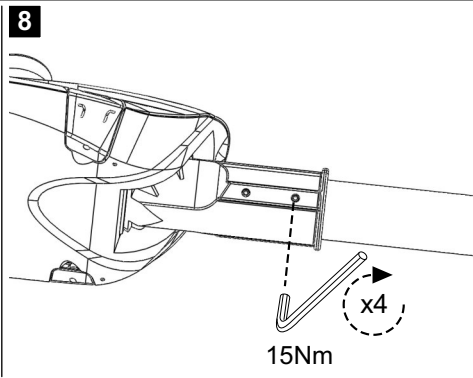
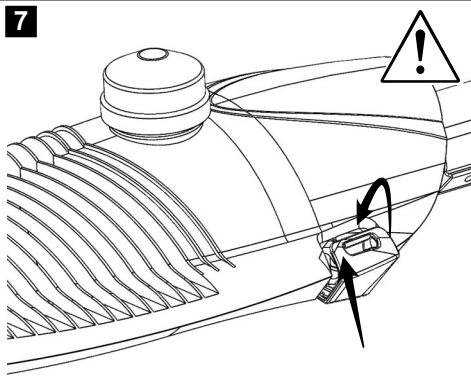

**i1** Maximum Mounting Height 12m.

**!** Ensure no cables are trapped when luminaire is closed.

 **Operation & Maintenance**  
Failed light source should be replaced promptly or the circuit switched off to avoid possible damage to control gear.

**Important - Safety**  
Before carrying out any servicing on these luminaires, ensure that the mains supply is fully isolated.

Disconnect the luminaire before insulation testing of the installation.

Circuit Breaker Type	16A(B)
Conquest	15

- i** Tested to BS EN 60598-2-3
- i** ta -20°C ... 25°C
- i** Between the control conductor and low voltage supply the maintained insulation level is basic.
- !** The light source contained in this luminaire shall only be replaced by the manufacturer or his service agent or a similar qualified person.

  
Do not stare at the operating light source

**For All Versions Example:** IP junction box / terminal block. If in doubt seek advice from qualified electrician.

- Mains supply to be fused using a minimum fuse size of (2A for the CQ20 / CQ30) or (4A for the CQ40 / CQ50 / CQ60 / CQ70)
- i2** Preparation of the ends of conductors: Wire ends stripped to the length 7mm - 8mm. Add ferrules (for 1.5mm<sup>2</sup> mini wires) to the wires if they are stranded.
- i3** Terminal block specified:
  - Terminal block specified:
  - The type of terminals: Screw.
  - Number of terminals: 3
  - Rated voltage: 450V
  - Rated connecting capacity: 16A to EN60598 and 24A to EN60998



**Example:**

Box: WISKA COMBI 308/5/S

Cable Gland x2: WISKA ESKVM20

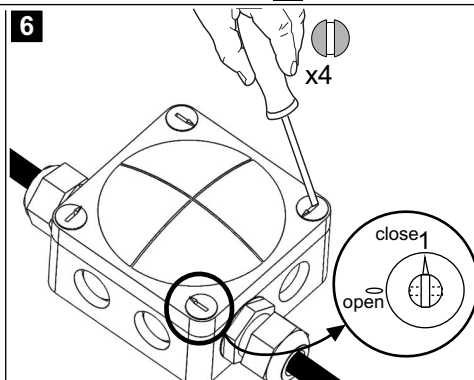
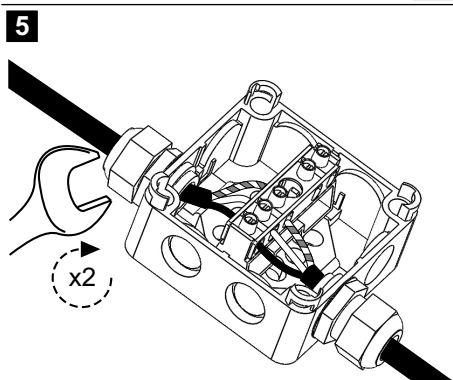
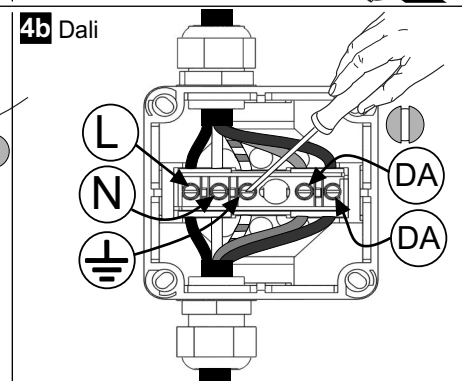
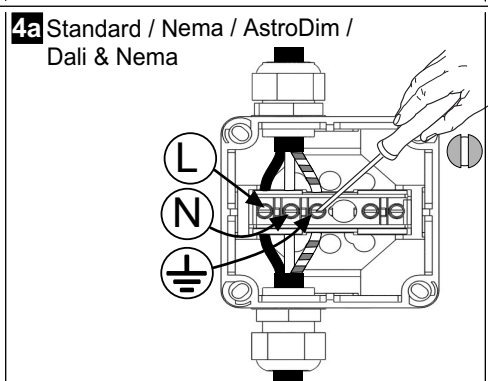
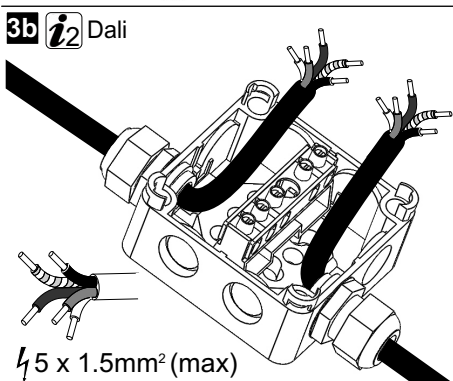
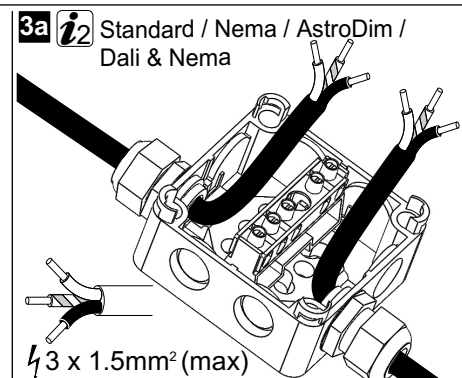
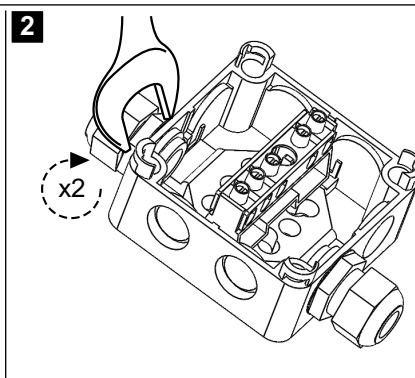
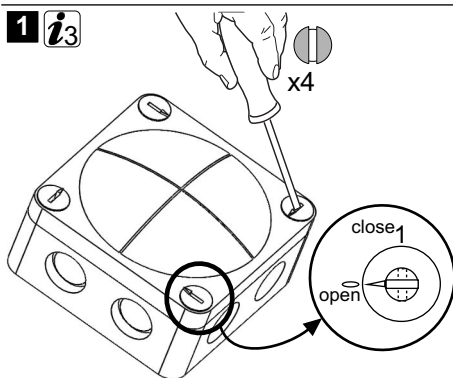

**For Standard / Nema / Dali & Nema / AstroDim Version Example:** Terminal block fused cut out. If in doubt seek advice from qualified electrician.



**i2** Preparation of the ends of conductors: Wire ends striped to the length 7mm - 8mm. Add ferrules (for 1.5mm<sup>2</sup>) to the wires if they are stranded.

**i4** Terminal block specified:

- Designed and tested in accordance with BS 7654:1997 and IEC/EN 60947-Part 1
- Detachable terminal block in extension trough facilitates termination of heavy duty cables
- Electroplated brass terminal blocks accept conductors up to 25mm<sup>2</sup>
- Number of terminals: 3
- The type of terminals: Screw
- Rated voltage: 230V
- Rated connecting capacity: 25A

**Example:**

FHD-0005 Single and double pole cut outs.

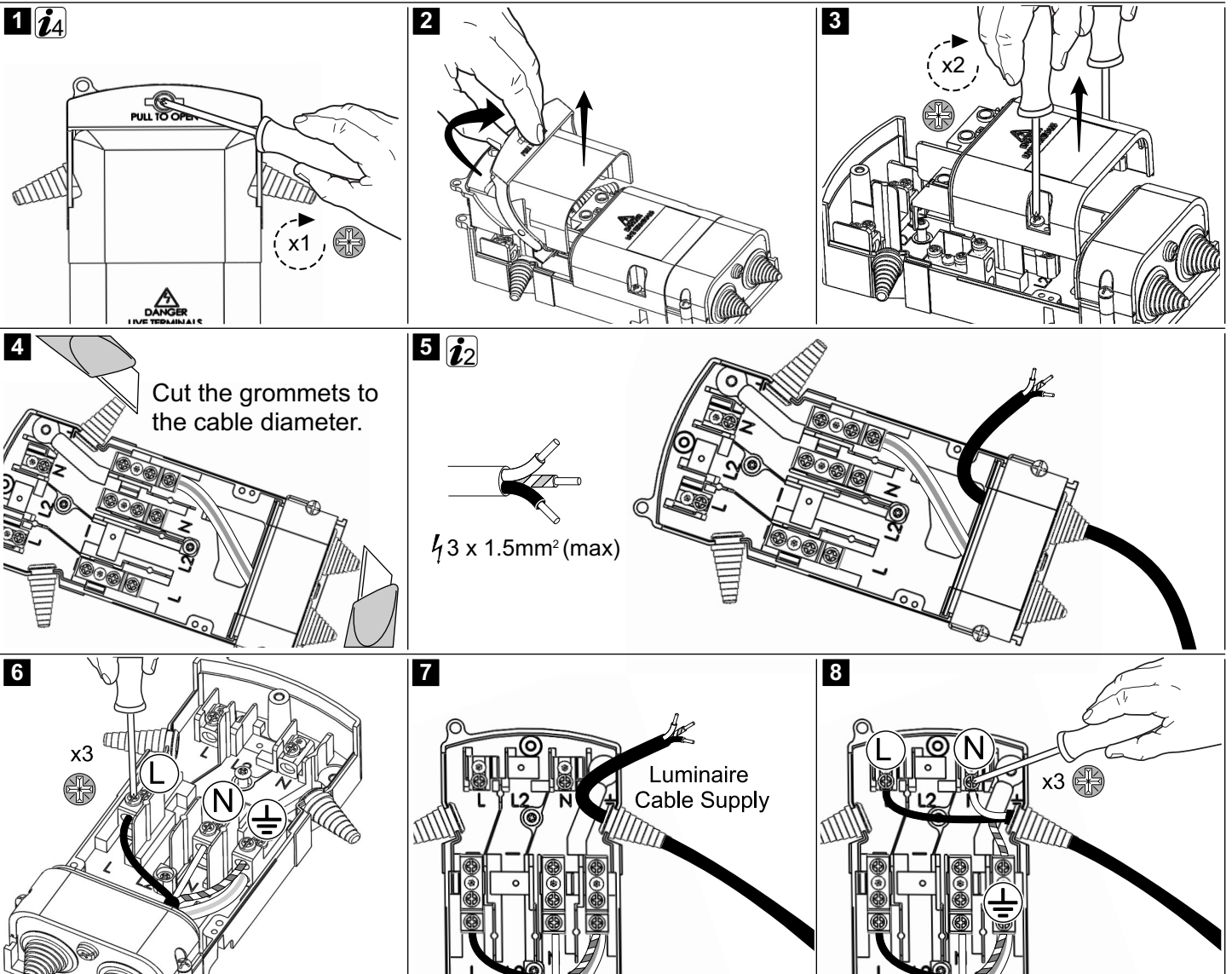

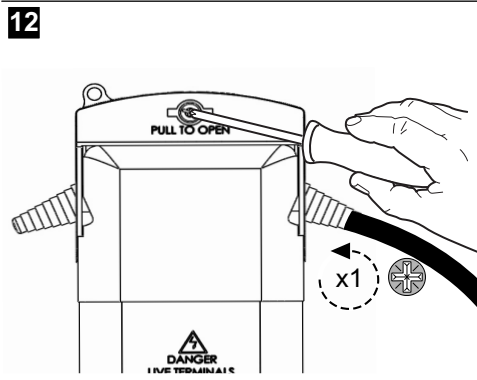
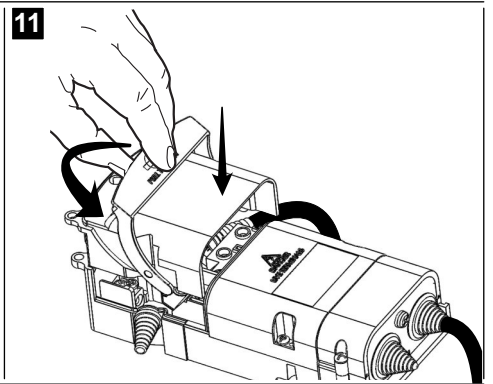
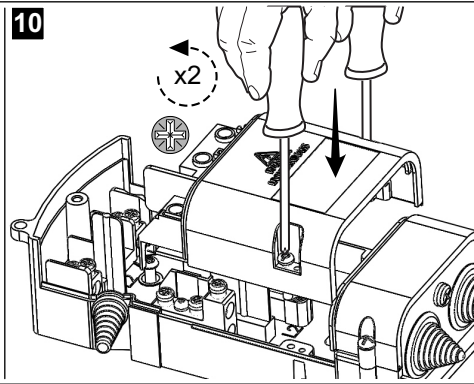
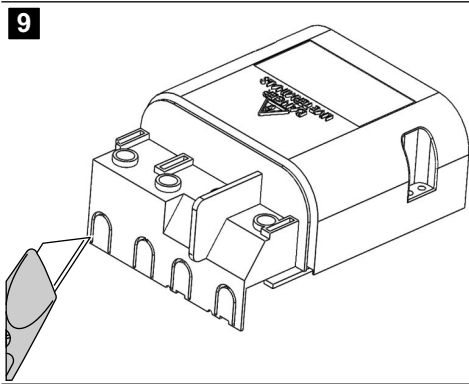

**For Dali Version Example:** Terminal block fused cut out. If in doubt seek advice from qualified electrician.

**i2** Preparation of the ends of conductors: Wire ends striped to the length 7mm - 8mm. Add ferrules (for 1.5mm<sup>2</sup>) to the wires if they are stranded.

**i4** Terminal block specified:

- Designed and tested in accordance with BS 7654:1997 and IEC/EN 60947-Part 1
- Detachable terminal block in extension trough facilitates termination of heavy duty cables
- Electroplated brass terminal blocks accept conductors up to 25mm<sup>2</sup>
- Number of terminals: 3
- The type of terminals: Screw
- Rated voltage: 230V
- Rated connecting capacity: 25A



**Example:**

FHD-0005 Single and double pole cut outs.

**i5** Wago 222 Series Non-Fused Terminal Block, 2 Way specified for dali luminaire only:

- Number of terminals: 2
- Wire size 28 - 12 AWG
- The type of terminals: Clip
- Rated voltage: 550V
- Rated connecting capacity: 22A



**Example:**

RS 222-412

2x Wago 222 Series Non-Fused Terminal Block, 2 Way

