

## GIMBLE OUT

inground fitting, LED, 3000K, stainless steel 316, 36°, IP67

The GIMBLE OUT 150 LED in-ground fitting with round bezel and transparent glass cover is equipped with an LED module. The head of the luminaire, which also contains the LED module, can be pulled out of the luminaire by 90°. With its IP67 protection class, the luminaire is suitable for outdoor use. The electrical connection is made directly to the 230V mains supply. This luminaire contains built-in LED lamps.

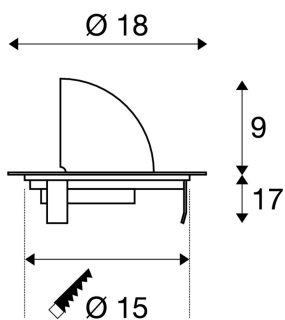

## TECHNICAL DATA

Item no.:	1000384
Lamps included	0
Primary nominal voltage	220-240V ~50/60Hz mA/V
Secondary power / secondary voltage	600 mA/V
Vertical tilting range	90 °
Vertical tilting range	0 °
Vertical tilting range	90 °
Horizontal rotation range	350 °
Height	13.1 cm
Diameter	18.0 cm
Installation diameter	15.0 cm
Installation depth	17.0 cm
Net weight	2.806 kg
Gross weight	2.995 kg
IP Code	IP 67
Safety class	I
Impact resistance class	IK08
Impact resistance	5 Joule
Assembly	Recessed
Assembly details	Ground, Ground with Acc.
Wattage	13.0 W
Lumen	1000 lm

## Accessories

1000655	Inground mounting pot , black for DASAR® PREMIUM and GIMBLE OUT
228730	CONNECTION BOX , 3-pin, IP68
233792	Inground mounting pot with cover for DASAR PREMIUM and GIMBLE OUT DN160

Colour temperature	3000 Kelvin
Beam angle	36 °
CRI	>80
Binning	6
LXXBXX data	L70B50
Service life	35000 h
Minimum ambient temperature	-20 °C
Maximum ambient temperature	45 °C
Mechanical loading	0 t
BIG WHITE Page	720

## Notes

---



---



---



---



---